

LIVING&CO[®]
STICK VACUUM CLEANER

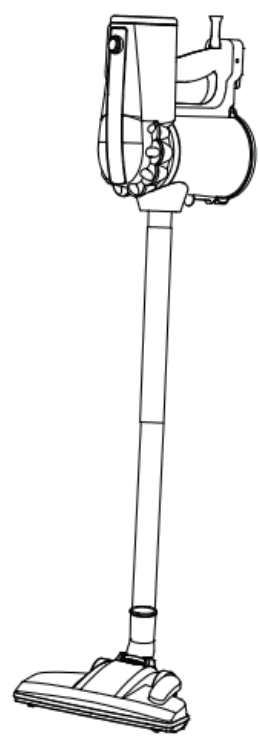

INSTRUCTION MANUAL
MODEL NO.:SL585GA06

AFTER SALES SUPPORT
☎ NZ 0800 422 274

PRODUCT OVERVIEW:

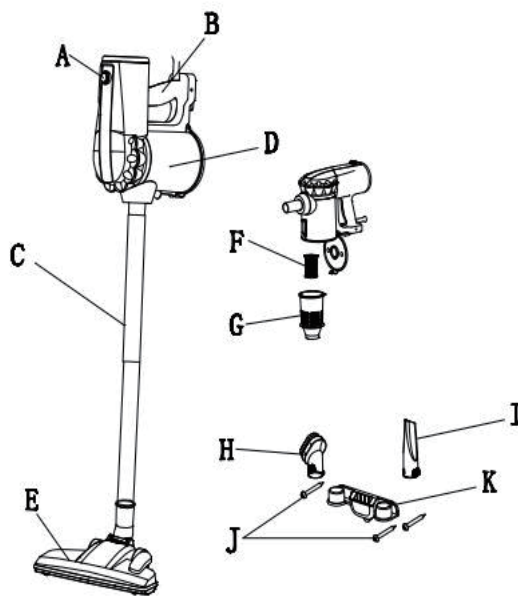

DESCRIPTION

- A. On/Off Switch
B. Handle
C. Vacuum Rod (2 parts)
D. Dust collection compartment
E. Floor vacuum head
F. HEPA filter
G. Filter cover
H. Small brush attachment
I. Nozzle attachment
J. Mounting screws
K. Wall bracket

1 LIVING&CO[®]

AFTER SALES SUPPORT
☎ NZ 0800 422 274

IMPORTANT SAFEGUARDS

Read this manual thoroughly before first use, even if you are familiar with this type of product. The safety precautions enclosed reduce the risk of fire, electric shock and injury when correctly adhered to:

READ ALL INSTRUCTIONS BEFORE USING YOUR VACUUM CLEANER AND KEEP THIS MANUAL FOR FUTURE REFERENCE. Always follow basic safety precautions and accident prevention measures when using an electrical appliance including the following:

1. Before using the appliance, check that the mains supply voltage corresponds to the voltage shown on the rating plate.
2. Always remove the plug from the power socket when the appliance is not in use and before carrying out any cleaning or maintenance operations.
3. Never use methylated spirits or other solvents to clean the appliance.
4. Do not use the appliance to vacuum up liquids or damp items.
5. This appliance is designed for attended use only, never leave the appliance unattended when it is switched on.
6. Keep the appliance out of reach from children or the infirm.
7. This appliance is intended for domestic use only. Use as described in this instruction booklet.
8. Do not operate the appliance if it has been dropped / damaged or appears to be faulty.
9. Do not handle the supply plug or the appliance with wet hands.
10. Do not pull or carry by the supply cord, or pull cord around sharp edges or corners.
11. If the supply cord is damaged, it must be replaced by the manufacturer or its service agent or a similarly qualified person in order to avoid a hazard.
12. This appliance can be used by children aged from 8 years and above and persons with reduced physical, sensory or mental capabilities or lack of experience and knowledge if they have been given supervision or instruction concerning use of the appliance in a safe way and understand the hazards involved.
13. Children shall not play with the appliance. Cleaning and user maintenance shall not be made by children without supervision.
14. Keep the appliance and its cord out of reach of children less than 8 years.
15. Do not remove the plug from the socket by pulling the cable or the appliance itself.
16. Do not use the appliance to vacuum anything that is burning or smoking such as matches, cigarette ends and hot ash.
17. Do not use the appliance on wet surfaces.
18. Do not obstruct the air intake or outlet vent.
19. Do not use the appliance to vacuum needles, drawing pins or strings.
20. Not intended for outdoor use.
21. Switch off the appliance using the on/off switch and the wall socket switch before removing the plug from the electrical socket outlet.
22. Keep end of hose, rods and other openings away from your face and body.
23. Do not use the vacuum cleaner without the dust collection container or filters in place.
24. Keep hair, loose clothing and all parts of the body away from openings and moving parts.

AFTER SALES SUPPORT
☎ NZ 0800 422 274

LIVING&CO[®] 2

WARNING!

Do not remove the plug from the socket by pulling the cable of the appliance.



Do not use the appliance on wet surfaces.



Do not run the appliance over the power cable.



Do not use the appliance to vacuum matches, cigarette ends or hot ash.



Do not obstruct the air intake or outlet vents.

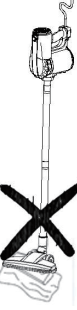

Do not use the appliance to vacuum sharp objects such as needles or drawing pins

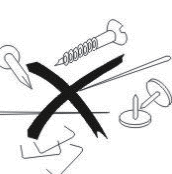

3 LIVING&CO[®]

AFTER SALES SUPPORT
☎ NZ 0800 422 274

ASSEMBLY AND OPERATION OF THE VACUUM CLEANER

Instructions for use:

1. Connect the two parts of the Vacuum Rod together (refer image below).
2. Insert one end of the vacuum rod onto the inlet nozzle of the main vacuum body.
3. Insert the floor vacuum head attachment nozzle onto the opposite end of the rod.
4. As an alternative to using the floor vacuum head, one of the multi brush attachments can be used (ideal for furniture / shelves etc).
5. Ensure the dust collection container is fitted correctly to the main body (refer 'Dust collection container removal and filter cleaning' section).
6. Unravel the supply cord ensuring it is untangled and clear of hazards, insert the supply plug into a suitable AS/NZS socket outlet, and switch the socket to the on position.
7. Whilst holding the appliance by the handle, switch the on/off switch on the main body to the on position, appliance will operate.
8. When you have finished using the appliance, switch off on the appliance, switch the supply socket switch off and remove the supply plug from socket outlet.
9. Check dust collection container contents and empty if required.
10. Store the product for later use in a dry, well ventilated location.
11. The appliance is provided with a wall mounting bracket which can support the vacuum and the (2) additional attachments. Ensure the wall bracket is securely attached.

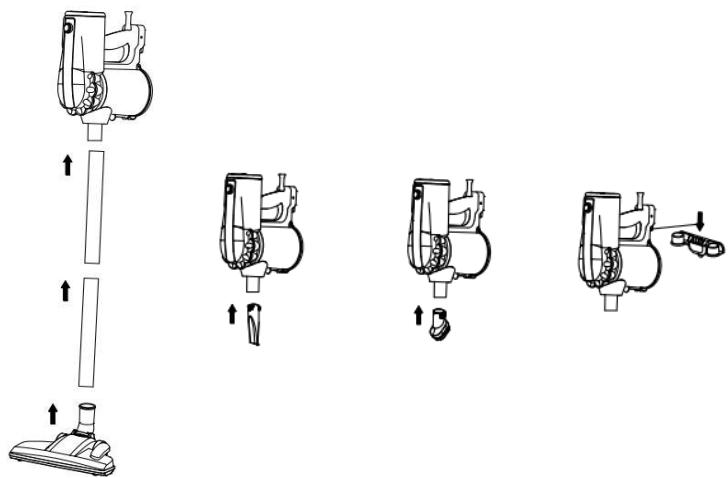

AFTER SALES SUPPORT
☎ NZ 0800 422 274

LIVING&CO[®] 4

Floor Vacuum Head

The floor vacuum head can be used on bare floors (wood / tile / vinyl / concrete etc). To assist with the movement and function of the vacuum head, the underside includes a brush which can be engaged by pressing the actuating button shown below.

For use on carpet / material surfaces the brush should be disengaged by pulling the lever up.

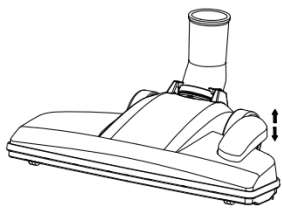

Emptying the dust collection container and filter removal / cleaning

Emptying the dust collection container

1. Push the release clip lever on the collection container body which will allow the hinged lower cover to open. Empty the dust container over a bin to remove the contents.
2. With one hand, reach in to hold the filter cover and rotate anti-clockwise to allow the filter cover to unlock and release, this can now be removed from the collection container.
3. Wipe any remaining surface dust / dirt from the filter cover.
4. Re-insert the filter cover to the collection container and rotate clock-wise to lock in position.
5. Close the lower hinged cover until it 'clicks' to lock in position.

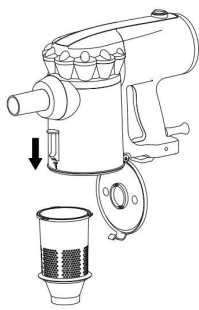

5 LIVING&CO[®]

AFTER SALES SUPPORT
☎ NZ 0800 422 274

Cleaning the filter

The filter should be cleaned regularly or after heavy use. To access the filter, follow the instructions for 'Emptying the dust collection container' up to instruction 3), then proceed as follows;

- 1). With the filter cover removed, the dust filter can now be removed from within the machine:

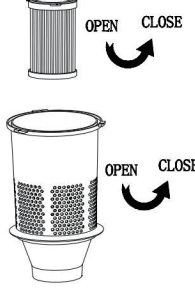

- 2). Remove the inner filter from the machine by rotating the filter body anti clock-wise to release, then pull away from the machine.

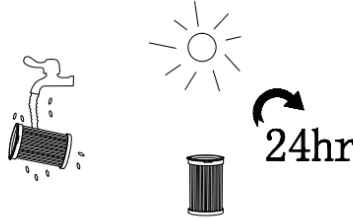

- 3). Wash the inner dust filter under running water to remove dust deposits and dirt.
- 4). Shake out all excess water, and leave to fully dry (naturally) for at least 24 hours before placing back into the machine.
- WARNING: Failure to follow this instruction will compromise safety and reduce the effectiveness of the vacuum. The filter cannot be cleaned in the washing machine.
- 5). Once completely dry, re-insert the filter back into the machine by aligning the locating ridges and rotating clockwise to lock in position.
- 6). Re-insert the filter cover to the collection container and rotate clock-wise to lock in position.
- 7). Close the lower hinged cover until it 'clicks' to lock in position.

AFTER SALES SUPPORT
☎ NZ 0800 422 274

LIVING&CO[®] 6

Cleaning the air outlet foam filter:

The air outlet filter should be cleaned periodically or after heavy use. This filter can be accessed by removing the motor end cover.

- 1). Twist the end cover anti-clockwise to the "open" position as shown by the product marking, the cover can then be detached from the body.
- 2). Remove the internal foam filter.

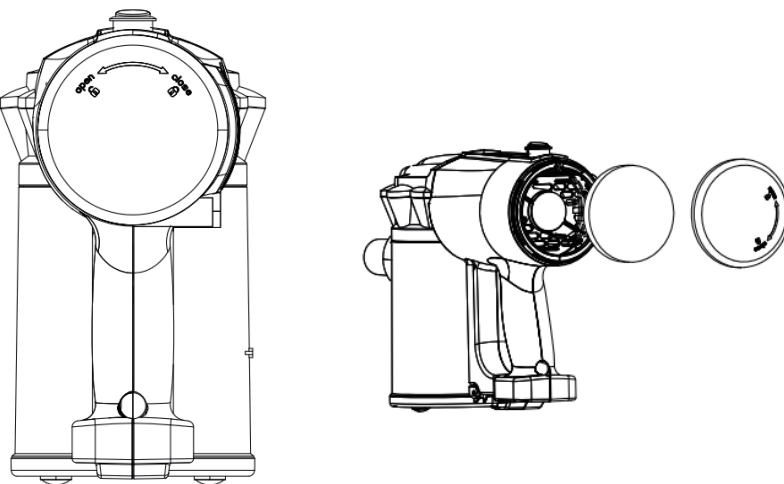

- 3). Wash the foam dust filter under running water to remove all dust deposits and dirt.
- 4). Shake out all excess water, and leave to fully dry (naturally) for at least 24 hours before placing back into the machine.
- WARNING: Failure to follow this instruction will compromise safety and reduce the effectiveness of the vacuum. The filter cannot be cleaned in the washing machine.
- 4). Once completely dry, re-insert the foam filter back into the enclosure recess.
- 5). Re-attach the motor end cover and rotate clock-wise to lock in position.

7 LIVING&CO[®]

AFTER SALES SUPPORT
☎ NZ 0800 422 274

Retention of the power cord

When not in use, unplug the appliance from the mains socket and wind the power cord around the body of the appliance as shown below.

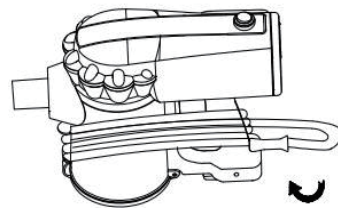

MAINTENANCE

It is important that the dust collection container is regularly emptied and that the inlet / outlet filters are regularly cleaned – follow the section 'Emptying the dust collection container' & 'filter removal' earlier in this manual.

If the body of the appliance requires cleaning, use a dry cloth. Do not use abrasive scouring pads or cleaning products.

TROUBLESHOOTING

Please check the following details before you have your appliance repaired by an authorised servicing agent.

Problem	Possible Cause	Possible Solution
Vacuum cleaner does not work	1. Check if the power plug is firmly inserted into the power outlet and the outlet switched on. 2. Check if the power switch of the appliance is on.	1. Insert the plug back into the power outlet and ensure it is switched on. 2. Switch the vacuum cleaner power switch to the on position.
Suction power becomes weak	1. Check if the vacuum rod or floor vacuum head is clogged or damaged. 2. Check if the dust collection container is full. 3. Check if the filters are clogged.	1. Remove the obstruction and clean any dust build up. 2. Empty the dust collection container. 3. Remove and clean the filters then reassemble.

AFTER SALES SUPPORT
☎ NZ 0800 422 274

LIVING&CO[®] 8

TECHNICAL SPECIFICATIONS

220-240V, 50/60Hz, 600W
Dust canister capacity: 0.5L

Responsible disposal

At the end of its working life, do not throw this appliance out with your household rubbish. Electrical and electronic products contain substances that can have a detrimental effect on the environment and human health if disposed of inappropriately. Observe any local regulations regarding the disposal of electrical consumer goods and dispose of it appropriately for recycling. Contact your local authorities for advice on recycling facilities in your area.



LIVING&CO[®]

Warranty

We pride ourselves on producing a range of quality home appliances that are both packed with features and completely reliable. We are so confident in our products,

we back them up with a 1 year warranty.

Now you too can relax knowing that you are covered.

Customer Helpline NZ: 0800 422 274

This Product is covered by 1 years warranty when accompanied by proof of purchase.

IM Version 1.0 – September 2018

AFTER SALES SUPPORT
☎ NZ 0800 422 274

LIVING&CO[®] 10